



MAGNOBOX® Rectangular Drainage Box Culverts



## MAGNOBOX® Rectangular Drainage Box Culverts

63 Different sizes

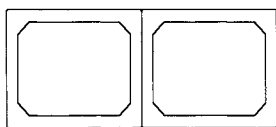
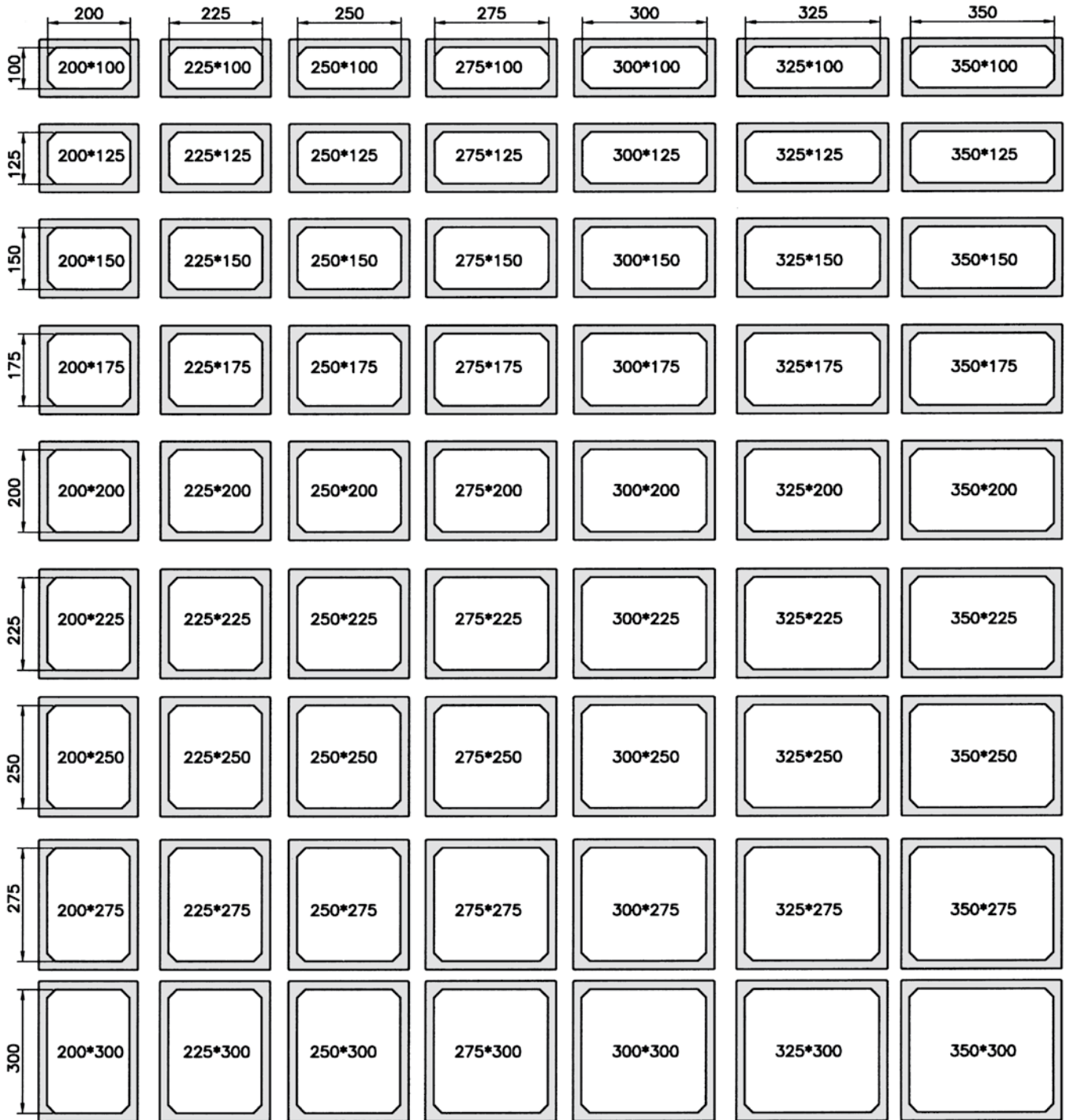

A pair of identical Box Culverts

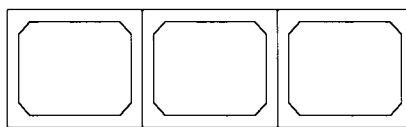

A trio of identical Box Culverts

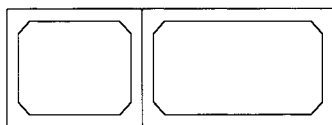

A pair of non-identical Box Culverts

- Several Box Culverts can be joined together to achieve large flow cross sections.
- Rectangular box culverts are also available in larger sizes.

MAGNOBOX® Rectangular Drainage Box Culverts

	Catalog no. model	Height x width A x B (cm)	Net section area S (m <sup>2</sup> )
Width 200	MBX-200x100	200x100	1.92
	MBX-200x125	200x125	2.42
	MBX-200x150	200x150	2.92
	MBX-200x175	200x175	3.42
	MBX-200x200	200x200	3.92
	MBX-200x225	200x225	4.42
	MBX-200x250	200x250	4.92
	MBX-200x275	200x275	5.42
	MBX-200x300	200x300	5.92
Width 225	MBX-225x100	225x100	2.17
	MBX-225x125	225x125	2.73
	MBX-225x150	225x150	3.30
	MBX-225x175	225x175	3.86
	MBX-225x200	225x200	4.42
	MBX-225x225	225x225	4.98
	MBX-225x250	225x250	5.54
	MBX-225x275	225x275	6.10
	MBX-225x300	225x300	6.76
Width 250	MBX-250x100	250x100	2.42
	MBX-250x125	250x125	3.04
	MBX-250x150	250x150	3.67
	MBX-250x175	250x175	4.30
	MBX-250x200	250x200	4.92
	MBX-250x225	250x225	5.54
	MBX-250x250	250x250	6.17
	MBX-250x275	250x275	6.79
	MBX-250x300	250x300	7.42
Width 275	MBX-275x100	275x100	2.67
	MBX-275x125	275x125	3.35
	MBX-275x150	275x150	4.05
	MBX-275x175	275x175	4.73
	MBX-275x200	275x200	5.42
	MBX-275x225	275x225	6.10
	MBX-275x250	275x250	6.79
	MBX-275x275	275x275	7.48
	MBX-275x300	275x300	8.17

	Catalog no. model	Height x width A x B (cm)	Net section area S (m <sup>2</sup> )
Width 300	MBX-300x100	300x100	2.92
	MBX-300x125	300x125	3.67
	MBX-300x150	300x150	4.42
	MBX-300x175	300x175	5.17
	MBX-300x200	300x200	5.92
	MBX-300x225	300x225	6.67
	MBX-300x250	300x250	7.42
	MBX-300x275	300x275	8.17
	MBX-300x300	300x300	8.92
Width 325	MBX-325x100	325x100	3.17
	MBX-325x125	325x125	3.98
	MBX-325x150	325x150	4.79
	MBX-325x175	325x175	5.60
	MBX-325x200	325x200	6.42
	MBX-325x225	325x225	7.23
	MBX-325x250	325x250	8.04
	MBX-325x275	325x275	8.85
	MBX-325x300	325x300	9.67
Width 350	MBX-350x100	350x100	3.42
	MBX-350x125	350x125	4.29
	MBX-350x150	350x150	5.17
	MBX-350x175	350x175	6.04
	MBX-350x200	350x200	6.92
	MBX-350x225	350x225	7.79
	MBX-350x250	350x250	8.67
	MBX-350x275	350x275	9.54
	MBX-350x300	350x300	10.42

- Several rectangular culvert units can be joined together to achieve larger flow sections.
- Rectangular culverts at larger dimensions can be ordered.

**Lifting and handling**

Each unit has 4 DEHA lifting lugs for lifting, handling and laying, **Make sure to keep away from the load when it is hoisted.**

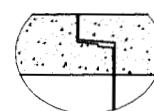
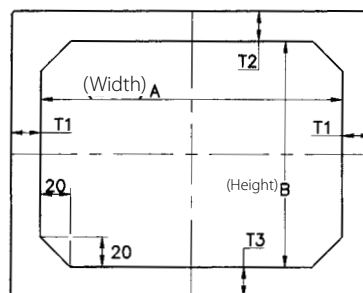

Detail of tongue and groove connection between units

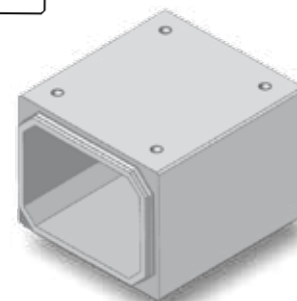

Prices by agreement

**General technical data**

1. The length of each unit is 2.5 meters.
2. Connection between the units is by tongue and groove.
3. The grade of concrete is B-50.
4. The reinforcement is by means of welded mesh in accordance with IS 4466 part 4. The concrete cover above the steel is 25 mm unless a larger cover is required.
5. The thickness of the walls, the ceiling and the floor is determined by the loads anticipated and the dimensions of the box culvert. The thicknesses are not required to be identical. Any thickness between 20 and 30 cm is available, (additional thicknesses by agreement).
6. The Manning Coefficient for calculating flow is 0.012 – 0.013.
7. Entry holes are available in the walls and ceiling as required.